



Terry College of Business
UNIVERSITY OF GEORGIA

SELF-GUIDED TOUR

Welcome to the Terry College's Business Learning Community. Covering 300,000 square feet, the six-building complex was completed in 2019. Designed for collaboration and built in classic Neo-Georgian style, the complex makes use of architectural ingenuity and modern technology to create an interconnected learning environment. This walking tour starts on the second floor of Correll Hall. Public parking is available in the North Campus Parking Deck and Tate Center Parking Deck.



DAVIS COURTYARD



FOLEY COURTYARD

1 CORRELL HALL

Correll Hall was the first building constructed and houses the college's graduate programs and administrative offices.

2 BO AND SHERRY MEANS FAMILY INNOVATION LAB

The Innovation Lab is a learning and work space that supports the university's Entrepreneurship Program. The room features a presentation space and the latest in educational technology.



3 GRADUATE COMMONS

Located on the ground floor of Correll Hall with a scenic view of Foley Courtyard, the Graduate Commons is a gathering and meeting space for Terry's graduate students.



4 BENSON HALL

Located on the eastern side of the BLC, Benson Hall is home to the college's management, management information systems and marketing departments.

5 AMOS HALL

Amos Hall is the center building of the BLC. Flanked by Moore-Rooker Hall and Benson Hall, it's the home of Casey Commons, the Rothenberger Café, and the finance and economics departments.

(Locations 6-19 are listed on back.)

6 TEAM ROOMS

The team rooms provide Terry students an engaging yet quiet environment for group study sessions and class projects.

7 UNDERGRADUATE PROGRAMS OFFICE

The Undergraduate Programs Office coordinates Terry major admissions, curriculum, advising and graduation certification, ensuring an excellent educational experience for Terry undergraduates.

8 STELLING FAMILY STUDY

On the second floor of Moore-Rooker Hall adjoining the Knox Veranda, the Stelling Family Study is a large, technology-furnished conference room and event space that students can also use as a spot to read, study and meet.

9 ROTHENBERGER CAFÉ

Located next to Casey Commons, the Rothenberger Café is where visitors can grab coffee, breakfast, sandwiches and salads. Open during fall and spring semesters.

10 CASEY COMMONS

Casey Commons is a 5,000-square-foot undergraduate meeting area filled with couches, cushioned chairs, meeting tables and high tables. Located in Amos Hall, it has seating for 150 and three study rooms facing Foley Courtyard.



11 FOLEY COURTYARD

The site of many Terry College events, the courtyard is surrounded by pavers and bricks donated by alumni and friends of the college.

12 BENN CAPITAL MARKETS LAB

The 1,800-square-foot Benn Capital Markets Lab is outfitted with Bloomberg Professional terminals, a stock ticker and cable news feeds.



13 TERRY COLLEGE TIMELINE

This timeline presents major milestones of the first 100 years of the Terry College of Business.

14 MOORE-ROOKER HALL

Moore-Rooker Hall faces Hull Street on the west side. It houses the J.M. Tull School of Accounting as well as the insurance, legal studies and real estate department.

15 MUSIC BUSINESS LAB

Equipped with a modern recording studio and a mixing table, the Music Business Lab allows students to gain hands-on experience in the music industry.



16 SANFORD AND BARBARA ORKIN HALL

Located at the corner of Baxter and Hull streets, Sanford and Barbara Orkin Hall honors the couple's longstanding support of UGA. The four-story building includes two auditoriums, four undergraduate classrooms, a behavioral lab, a computer lab for marketing research, six team rooms, nine interview rooms, and the offices for Terry's Undergraduate Student Services.

17 UNDERGRADUATE STUDENT SERVICES

The Office of Undergraduate Student Services provides professional development and connects students to internship and full-time employment opportunities. The USS also houses the Terry Women's Initiative, Terry Ambassadors and Terry student organizations.

18 IVESTER HALL

Ivester Hall is named for 1969 accounting graduate M. Douglas (Doug) Ivester. Located at the corner of Baxter and Lumpkin streets, the building features a 350-seat auditorium, three undergraduate classrooms, a seminar room and two conference rooms. It is also home to the Selig Center for Economic Growth, Terry College's marketing and communications, information technology, and business offices.

19 COCA-COLA PLAZA

Named in recognition of many UGA alumni and friends associated with the Coca-Cola family of companies, Coca-Cola Plaza sits between Ivester Hall and Sanford and Barbara Orkin Hall and serves as the front entryway into the Business Learning Community.



CLASSROOMS / AUDITORIUMS

The Business Learning Community makes smart use of instructional technology. Every classroom is equipped with two projectors and cameras that allow for remote guest speakers and recording capabilities.

SELF-GUIDED TOUR



Terry College of Business
UNIVERSITY OF GEORGIA

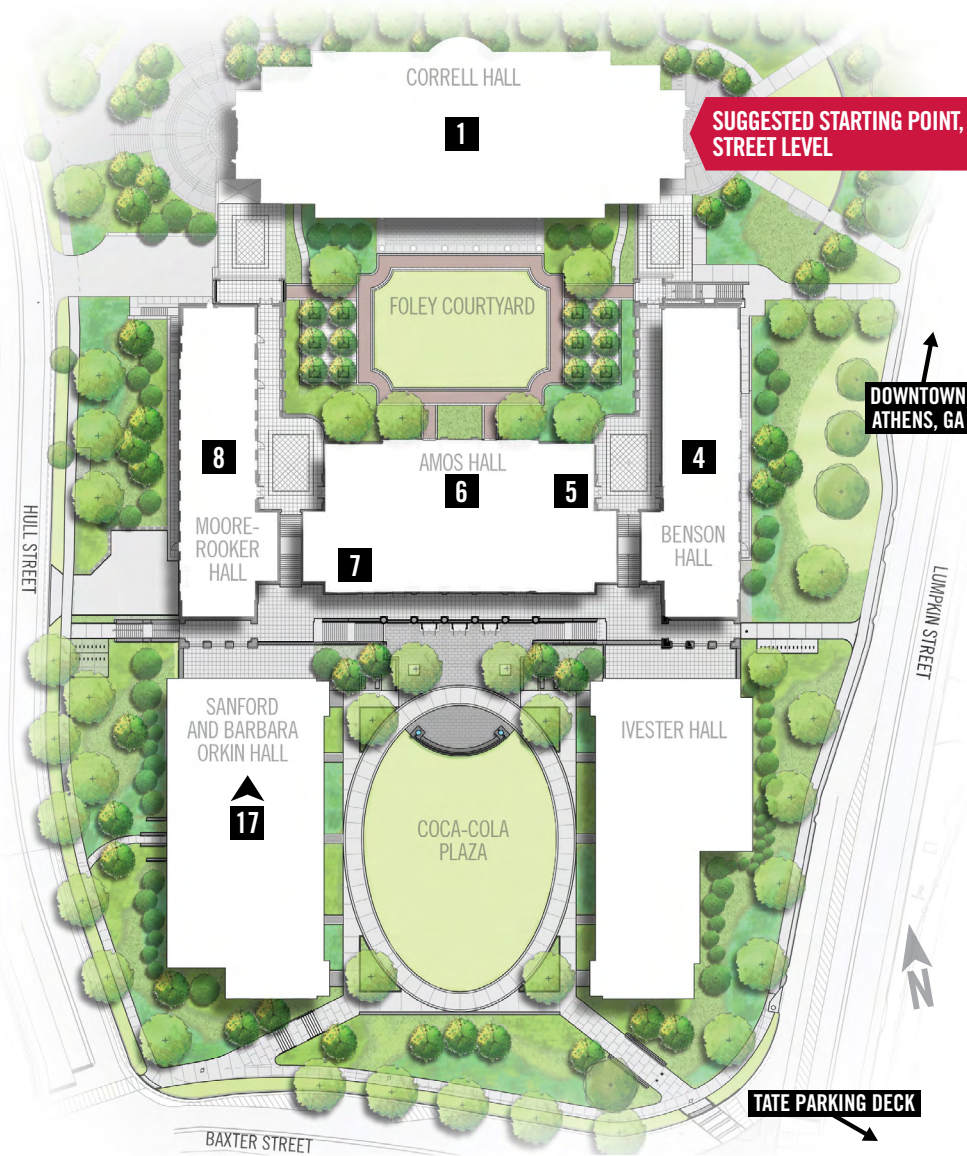

BUSINESS LEARNING COMMUNITY: 2ND FLOOR

1 CORRELL HALL

All public access doors from outside open to the 2nd floor; elevators and stairs are at both ends of the building

2 BO AND SHERRY MEANS FAMILY INNOVATION LAB*

Located on the 1st floor of Correll Hall

3 GRADUATE COMMONS*

Located on the 1st floor of Correll Hall

If you'd like to visit our MBA or MSBA programs, please take the elevator to the MBA Suite located at 314 Correll Hall

Exit Correll Hall on the 2nd floor Lumpkin Street side and turn right down the walkway

4 BENSON HALL

5 AMOS HALL

Located on the right of the walkway, the double doors open to the 2nd floor

6 TEAM ROOMS*

Located on the 2nd floor of Amos Hall

7 UNDERGRADUATE PROGRAMS OFFICE

Located on the 2nd floor of Amos Hall

Step outside through the double doors and across the Knox Veranda to Moore-Rooker Hall

8 STELLING FAMILY STUDY

Located on the 2nd floor of Moore-Rooker

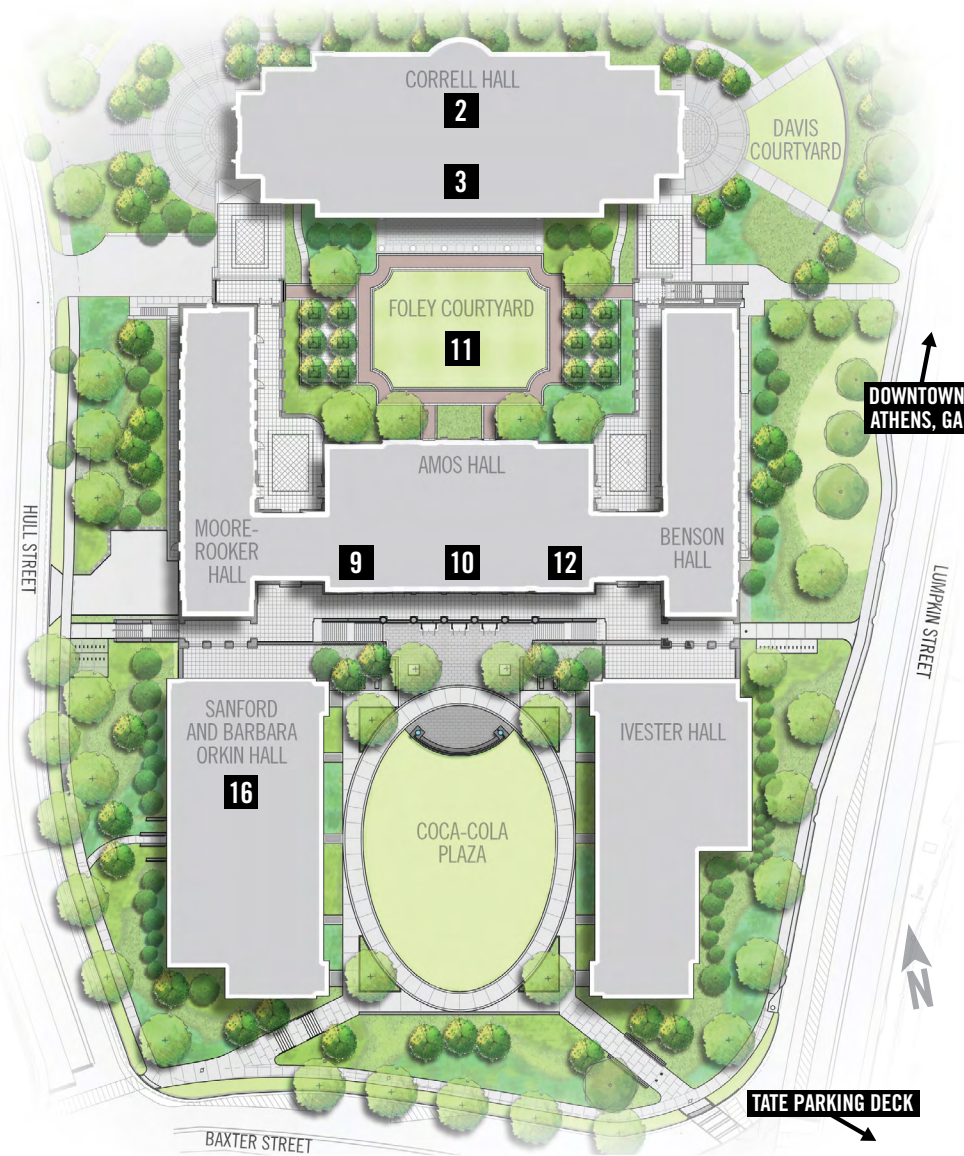

BUSINESS LEARNING COMMUNITY: 1ST FLOOR

Return to Amos Hall and take stairs or elevator to 1st floor

9 ROTHENBERGER CAFÉ

Located on the 1st floor of Amos Hall

10 CASEY COMMONS

Located on the 1st floor of Amos Hall

11 FOLEY COURTYARD

Accessed from the 1st floor level of Amos Hall

12 BENN CAPITAL MARKETS LAB*

Located on the 1st floor of Amos Hall

Take the elevator next to the lab to ground floor

13 TERRY COLLEGE TIMELINE

On the south side of Amos Hall

14 MOORE-ROOKER HALL

15 MUSIC BUSINESS LAB*

Located on the ground floor of Moore-Rooker Hall

To visit our MAcc program, take the elevator to the MAcc Accounting Suite at A301 Moore-Rooker Hall

16 SANFORD AND BARBARA ORKIN HALL

Access from the ground floor of Moore-Rooker Hall or the walkway from the 1st floor

Elevators are at the north end, stairs at both ends

17 UNDERGRADUATE STUDENT SERVICES

To visit the Undergraduate Student Services office, take the elevator or stairs up to the 3rd floor of Sanford and Barbara Orkin Hall

18 IVESTER HALL

Access the ground floor from the east side of Coca-Cola Plaza or from the walkway on the first floor

19 COCA-COLA PLAZA

Includes donor plaza and water feature

CLASSROOMS / AUDITORIUMS

Teaching spaces are located in every building of the Business Learning Community with most classrooms located on the ground and first floors.

* Can be seen through glass, but advance arrangements must be made to unlock and enter these rooms.